



## FASTENERS



## BOLTS, SCREWS AND SOCKETS

### HEXAGON HEAD SCREWS

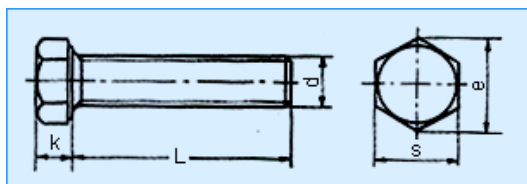
**DIN 933**

**STRENGTH GRADE**

8.8  
10.9  
12.9

Thread size	M4	M5	M6	M8	M10	M12	M14	M16	M18	M20	M22	M24	M27	M30
Pitch	0.7	0.8	1	1.25	1.5	1.75	2	2	2.5	2.5	2.5	3	3	3.5
k	2.8	3.5	4	5.3	6.4	7.5	8.8	10	11.5	12.5	14	15	17	18.7
e	Grade A	7.66	8.79	11.05	14.38	18.9	21.1	24.49	26.75	30.14	33.53	35.72	35.98	45.2
	Grade B	-	8.63	10.89	14.2	18.72	20.88	23.91	26.17	29.56	32.95	35.03	39.55	50.85
S	7	8	10	13	17	19	22	24	27	30	32	36	41	46
L	8-40	8-40	8-50	12-60	16-60	20-80	25-80	30-100	30-100	40-100	50-100	50-100	60-100	70-100

mm

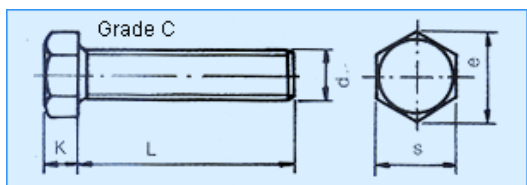
### HEXAGON HEAD SCREWS

**DIN 558**

**STRENGTH GRADE**

8.8

Thread size	M5	M6	M8	M10	M12	M16	M20	M24	M30	M36
Pitch	0.8	1	1.25	1.5	1.75	2	2.5	3	3.5	4
k	3.5	4	5.3	6.4	7.5	10	12.5	15	18.7	22.5
e	8.63	10.89	14.2	18.72	20.88	26.17	32.95	39.55	50.85	60.79
S	8	10	13	17	19	24	30	36	46	55
L	10-40	12-50	16-65	16-80	20-100	25-100	30-100	35-100	40-100	50-100

mm

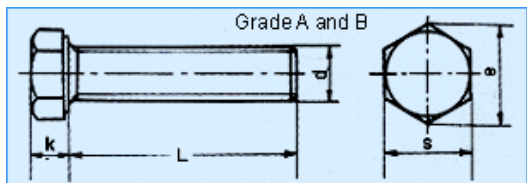
### HEXAGON HEAD SCREWS

**ISO 4017**

**STRENGTH GRADE**

8.8  
10.9  
12.9

Thread size	M5	M6	M8	M10	M12	M16	M20	M24	M30	M36
Pitch	0.8	1	1.25	1.5	1.75	2	2.5	3	3.5	4
k	3.5	4	5.3	6.4	7.5	10	12.5	15	18.7	22.5
e	Grade A	8.79	11.05	14.38	17.77	20.03	26.75	33.53	39.98	-
	Grade B	-	-	-	-	-	26.17	32.95	39.55	50.85
S	8	10	13	16	18	24	30	36	46	55
L	8-40	8-50	12-60	16-60	20-80	30-100	40-100	50-100	70-100	80-100

mm

## HEXAGON BOLTS WITH HEXAGON NUT

### DIN 7990

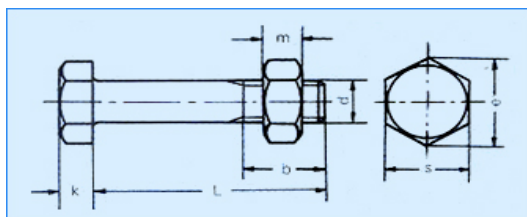

**STRENGTH GRADE**

10.9

	mm						
d1	M12	M16	M20	M22	M24	M27	M30
d	17.75	21	23.5	25.5	26	29	30.5
e	20.88	26.17	32.95	35.03	39.55	45.20	50.85
k	8	10	13	14	15	17	19
m	10	13	16	18	19	22	24
s	19	24	30	32	36	41	46
L	30-120	35-150	40-175	40-200	45-200	60-200	80-200

## HEXAGON HEAD BOLTS

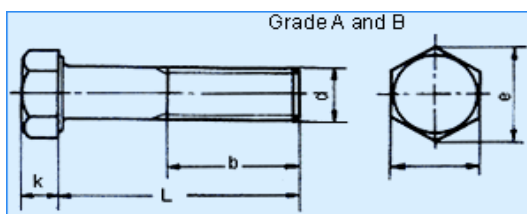
### DIN 931



**STRENGTH GRADE**

 8.8  
 10.9  
 12.9

	mm													
Thread size	M4	M5	M6	M8	M10	M12	M14	M16	M18	M20	M22	M24	M27	M30
Pitch	0.7	0.8	1	1.25	1.5	1.75	2	2	2.5	2.5	2.5	3	3	3.5
b	125	14	16	18	22	26	30	34	38	42	46	50	54	60
	L ≥ 200	-	22	24	28	32	36	40	44	48	52	56	60	66
	200	-	-	-	-	45	49	53	57	61	65	69	73	79
k	2.8	3.5	4	5.3	6.4	7.5	8.8	10	11.5	12.5	14	15	17	18.7
e	A	7.66	8.79	11.05	14.38	18.9	21.1	24.49	26.75	30.14	33.53	35.72	39.98	45.2
	B	-	8.63	10.89	14.20	18.72	20.88	23.91	26.17	29.56	32.95	35.03	39.55	45.2
S	7	8	10	13	17	19	22	24	27	30	32	36	41	46
L	25-40	25-50	30-60	35-80	40-100	45-120	50-140	55-160	65-180	65-200	70-220	80-240	90-260	90-300

## HEXAGON BOLTS WITH LARGE WIDTHS ACROSS FLATS

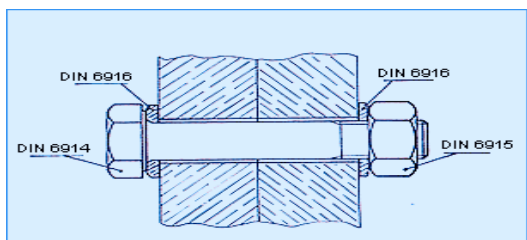
### DIN 6914



**STRENGTH GRADE**

10.9

	mm			
DIN6914	Diameter d	M12-M30	Length L	30-200
Nuts	Diameter D	M12-M30	-	-
Washers	Diameter d	M13-M31	-	-

## HEXAGON HEAD BOLTS

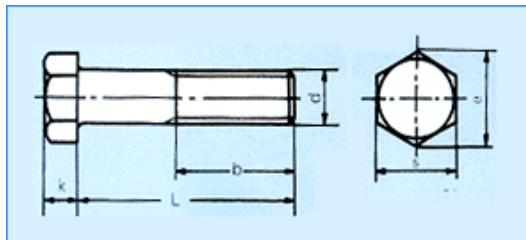
### DIN 601



#### STRENGTH GRADE

4.8

mm

Thread size	M5	M6	M8	M10	M12	M16	M20	M24	M27	M30	M36
Pitch	0.8	1	1.25	1.5	1.75	2	2.5	3	3	3.5	4
b	L ≤ 125	16	18	22	26	30	38	46	54	60	66
	125 < L ≤ 200	22	24	28	32	36	44	52	60	66	72
	L > 200	35	37	41	45	49	57	65	73	79	85
k	3.5	4	5.3	6.4	7.5	10	12.5	15	17	18.7	22.5
e	8.63	10.89	14.2	18.72	20.88	26.17	32.95	39.55	45.2	50.85	60.79
S	8	10	13	17	19	24	30	36	41	46	55
L	25-50	30-60	35-80	40-100	45-100	55-100	65-200	80-240	90-300	90-300	300

## HEXAGON HEAD BOLTS

### ISO 4014

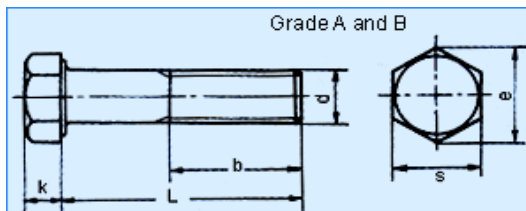

#### STRENGTH GRADE

8.8  
10.9  
12.9

mm

Thread size	M5	M6	M8	M10	M12	M16	M20	M24	M30	M36+
Pitch	0.8	1	1.25	1.5	1.75	2	2.5	3	3.5	4
b	L ≤ 125	16	18	22	26	30	38	46	54	66
	125 < L ≤ 200	-	-	-	-	-	44	52	60	72
	L > 200	-	-	-	-	-	-	73	85	97
k	3.5	4	5.3	6.4	7.5	10	12.5	15	18.7	22.5
e	Grade A	8.79	11.05	14.38	17.77	20.03	26.75	33.53	39.98	-
	Grade B	-	-	-	-	-	26.17	32.95	39.56	50.85
S	8	10	13	16	18	24	30	36	46	55
L	25-50	30-60	35-80	40-100	45-120	55-160	65-200	80-240	90-300	300

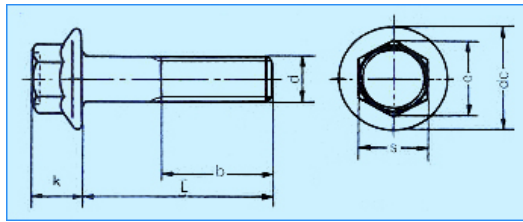
**HEX FLANGE BOLTS & SCREWS**
**DIN 6921**

STRENGTH GRADE
4.8
8.8

mm

Thread size	M5	M6	M8	M10	M12	M14	M16	M20
Pitch	0.8	1	1.25	1.5	1.75	2	2	2.5
b	L ≤ 125	16	18	22	26	30	34	38
	125 < L ≤ 200	-	-	28	32	36	40	44
	L > 200	-	-	-	-	-	-	57
dc	11.8	14.2	18	22.3	26.6	30.5	35	43
k	5.4	6.6	8.1	9.2	11.5	12.8	14.4	17.1
e	8.71	10.95	14.26	16.5	17.62	19.86	23.15	29.87
s	8	10	13	15	16	18	21	27
L	oct-50	dic-60	16-80	20-100	25-120	30-140	35-160	40-200

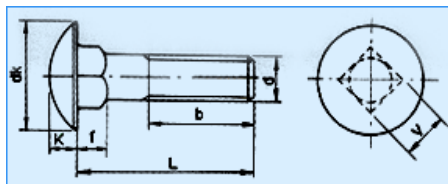
**MUSHROOM HEAD SQUARE NECK BOLTS**
**DIN 603**

STRENGTH GRADE
4.8
8.8

mm

Thread size	M6	M8	M10	M12
Pitch	1	1.25	1.5	1.75
b	L ≤ 125	18	22	26
	125 < L ≤ 200	24	28	32
	L > 200	-	41	45
dk	16.55	20.65	24.65	30.65
f	4.6	5.6	6.6	8.75
k	3.88	4.88	5.38	6.95
v	6.48	8.58	1.58	12.7
L	16-80	20-100	20-100	30-100

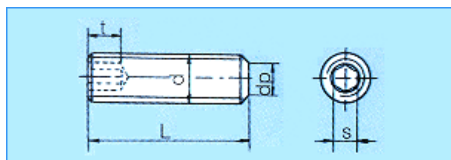
**HEXAGON SOCKET SET SCREWS WITH FLAT POINT**
**DIN 913**

mm

Thread size	M3	M4	M5	M6	M8	M10	M12	M16	M20
dp	2	2.5	3.5	4	5.5	7	8.5	12	15
s	1.5	2	2.5	3	4	5	6	8	10
t	1.2	1.5	2	2	3	4	4.8	6.4	8
L	4-16	5-20	6-25	8-30	10-40	12-50	16-60	20-60	25-60

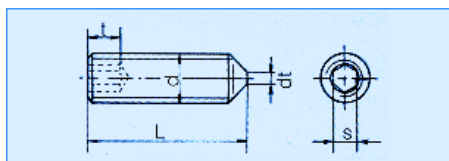
**HEXAGON SOCKET SET SCREWS WITH CONE POINT**
**DIN 914**

mm

Thread size	M3	M4	M5	M6	M8	M10	M12	M16	M20
dt	-	-	-	1.5	2	2.5	3	4	5
s	1.5	2	2.5	3	4	5	6	8	10
t	1.2	1.5	2	2	3	4	4.8	6.4	8
L	5-16	6-20	8-25	10-30	12-40	16-50	20-60	25-60	30-60

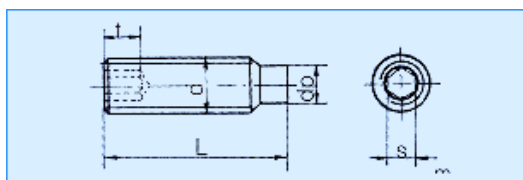
**HEXAGON SOCKET SET SCREWS WITH DOG POINT**
**DIN 915**

mm

Thread size	M3	M4	M5	M6	M8	M10	M12	M16	M20
dp	2	2.5	3.5	4	5.5	7	8.5	12	15
s	1.5	2	2.5	3	4	5	6	8	10
t	1.2	1.5	2	2	3	4	4.8	6.4	8
Z	short	0.75	1	1.25	1.5	2	2.5	4	5
	Long	1.5	2	2.5	3	4	5	6	8
L	6-16	8-20	10-25	14-30	16-40	20-50	25-60	30-60	35-60

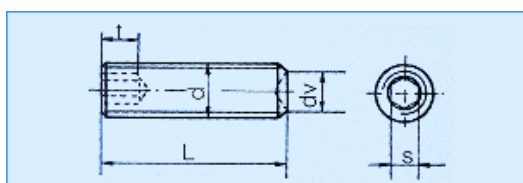
**HEXAGON SOCKET SET SCREWS WITH CUP POINT**
**DIN 916**

mm

Thread size	M3	M4	M5	M6	M8	M10	M12	M16	M20
dv	1.4	2	2.5	3	5	6	8	10	14
s	1.5	2	2.5	3	4	5	6	8	10
t	1.2	1.5	2	2	3	4	4.8	6.4	8
L	4-16	5-20	6-25	8-30	10-40	12-50	16-60	20-60	25-60

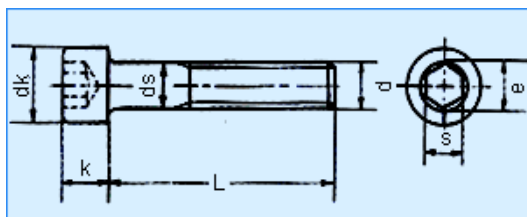
**HEXAGON SOCKET HEAD CAP SCREWS**
**DIN 912**

**STRENGTH GRADE**

8.8  
10.9  
12.9

Thread size	M3	M4	M5	M6	M8	M10	M12	M14	M16	M20
pitch	0.5	0.7	0.8	1	1.25	1.5	1.75	2	2	2.5
dk	5.32	6.78	8.28	9.78	12.73	15.73	17.73	20.67	23.67	29.67
ds	3	4	5	6	8	10	12	14	16	20
k	2.86	3.82	4.82	5.7	7.64	9.64	11.57	13.57	15.57	19.48
e	2.87	3.44	4.58	5.72	6.86	9.15	11.43	13.72	16	19.44
s	2.5	3	4	5	6	8	10	12	14	17
L	5-30	6-40	8-50	10-60	12-80	16-100	20-120	25-140	25-160	30-200

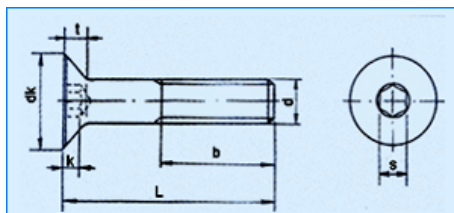
mm

**HEXAGON SOCKET COUNTERSUNK HEAD CAP SCREWS**
**DIN 7991**

Thread size	M3	M4	M5	M6	M8	M10	M12	M16	M20	
b	L < 125	12	14	16	18	22	26	30	38	46
	125 < L ≤ 200				24	28	32	36	44	52
	L > 200						45	49	57	65
dk	6	8	10	12	16	20	24	30	36	
k	1.70	2.30	2.80	3.30	4.40	5.50	6.50	7.50	8.50	
s	2.00	2.50	3.00	4.00	5.00	6.00	8.00	10.0	12.0	
t	0.95	1.55	2.05	2.25	3.20	4.10	4.30	5.00	5.60	
L	8-30	8-40	10-50	12-50	16-60	20-70	25-70	35-90	40-100	

mm

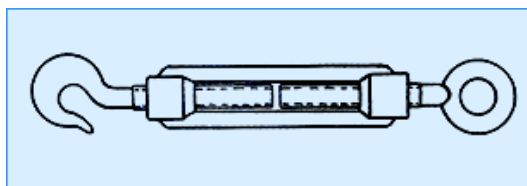
**TURNBUCKLE WITH HOOK AND EYE**
**DIN 1480**

SIZE AVAILABLE										
THREAD SIZE	6X10	8X110	10X12	12X12	14X14	16X17	20X20	22X22	24X25	30X25

mm

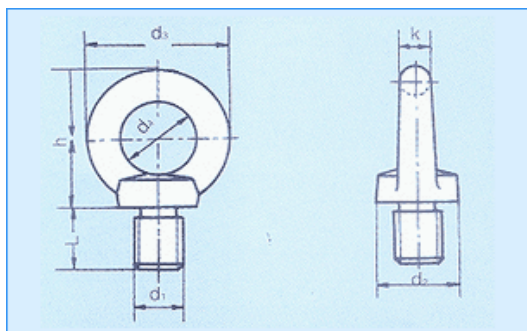
**LIFTING EYE BOLTS**
**DIN 580**

	mm							
d1	M8	M10	M12	M16	M20	M24	M30	M36
d2	20	25	30	35	40	50	65	75
d3	36	45	54	63	72	90	108	128
d4	20	25	30	35	40	50	60	70
h	36	45	53	62	71	90	109	128
k	8	10	12	14	16	20	24	28
L	13	17	20.5	27	30	36	45	54

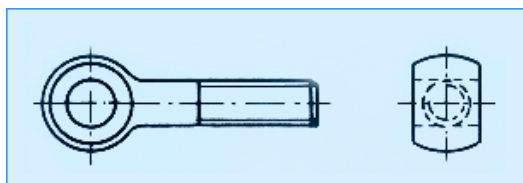
**EYE BOLTS**
**DIN 444**

	mm								
Thread size	M5	M6	M8	M10	M12	M16	M20	M24	M30
Length	30-50	30-60	40-80	50-100	60-120	60-150	65-200	80-200	90-300

**ANCHOR BOLTS**
**DIN 529**

	mm						
Thread size	M8	M10	M12	M16	M20	M24	M30
Length	80-125	111-160	180	200	250	320	400





## WELD SCREWS

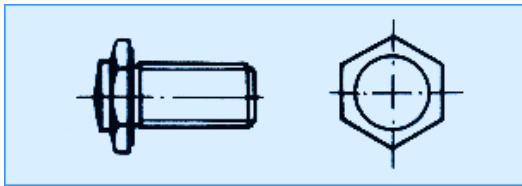

Thread size	M8×19
-------------	-------

## DRAW BOLTS

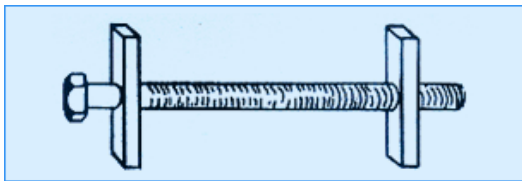

size	1/4-20 × 3-1/2	1/4-20 × 4
------	----------------	------------

## ACOUSTICAL TOGGLES

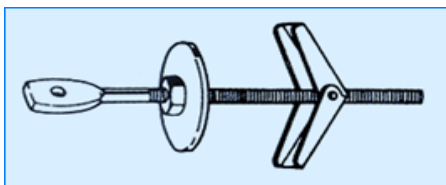

size	1/4-20 × 4-1/4
------	----------------

## NUTS

### HEXAGON NUTS

DIN 555

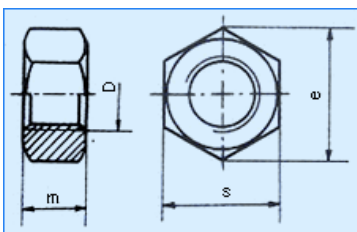

Thread size	M5	M6	M8	M10	M12	M16	M20	M24	M30	M36	M42	M48	M56
Pitch	0.8	1	1.25	1.5	1.75	2	2.5	3	3.5	4	4.5	5	5.5
m	4	5	6.5	8	10	13	16	19	24	29	34	38	45
e	8.63	10.89	14.2	18.72	20.88	26.17	32.95	39.55	50.85	60.79	71.3	82.6	93.56
s	8	10	13	17	19	24	30	36	46	55	65	75	85

mm

## HEXAGON NUTS

## DIN 934

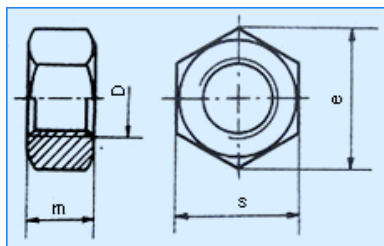

mm

Thread size	M2	M3	M4	M5	M6	M8	M10	M12	M16
Pitch	0.4	0.5	0.7	0.8	1	1.25	1.5	1.75	2
m	1.6	2.4	3.2	4	5	6.5	8	10	13
e	4.32	6.01	7.66	8.79	11.05	14.38	18.9	21.1	16.75
s	4	5.5	7	8	10	13	17	19	24
Thread size	M20	M24	M30	M36	M42	M48	M56		
Pitch	2.5	3	3.5	4	4.5	5	5.5		
m	16	19	24	29	34	38	45		
e	32.95	39.55	50.85	60.79	71.3	82.6	93.56		
s	30	36	46	55	65	75	85		

## BRIGHT MILD STEEL HEX NUTS

## B.S. 1083

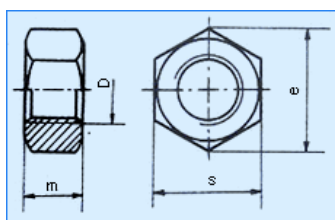

inches

Thread size	1/8	5/32	3/16	1/4	5/16	3/8	7/16	1/2
Pitch	40	32	24	20	18	16	14	12
s	5.59	7.6	8.23	11.30	13.34	15.24	18.03	20.83
e	6.40	8.20	9.50	13.00	15.30	17.50	20.70	24.10
m	3.04	3.88	4.24	5.08	6.35	7.92	9.53	11.10

## HEXAGON NUTS

B.S. 1768

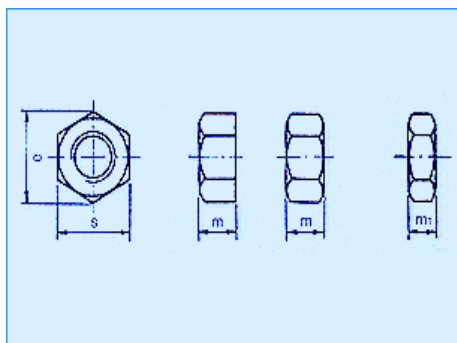

inches

Thread size	1/4	5/16	3/8	7/16	1/2	9/16	5/8	3/4	7/8
e	0.505	0.577	0.650	0.794	0.866	1.010	1.083	1.300	1.515
s	0.437	0.500	0.562	0.687	0.750	0.875	0.937	1.125	1.312
m	0.224	0.271	0.333	0.380	0.442	0.489	0.552	0.651	0.760
m1	0.286	0.333	0.411	0.458	0.567	0.614	0.724	0.822	0.916
m2	0.161	0.192	0.224	0.255	0.317	0.349	0.380	0.432	0.494
Thread size	1	1 1/8	1 1/4	1 3/8	1 1/2	1 3/4	2		
e	1.732	1.948	2.165	2.382	2.598	3.031	3.461		
s	1.500	1.687	1.875	2.062	2.250	2.625	3.000		
m	0.874	0.989	1.087	1.197	1.311	1.530	1.754		
m1	1.015	1.176	1.275	1.400	1.530	-	-		
m2	0.562	0.629	0.744	0.806	0.874	0.999	1.129		

## HEXAGON NUTS

B.S. 1769

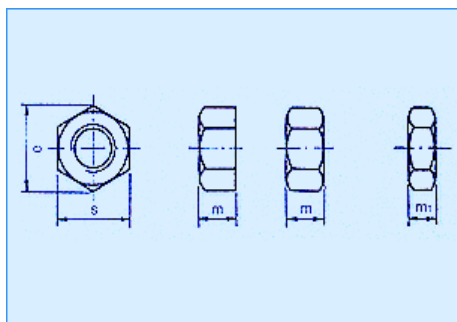

inches

Thread size	1/2	5/8	3/4	7/8	1	1 1/8	1 1/4	1 3/8	1 1/2	1 3/4	2
P UNC	13	11	10	9	8	7	7	6	6	5	4 1/2
P UNF	20	18	16	14	12	12	12	12	12	-	-
e	1.01	1.23	1.44	1.66	1.88	2.09	2.31	2.53	2.74	3.18	3.61
s	0.875	1.062	1.250	1.437	1.625	1.812	2.000	2.187	2.375	2.750	3.125
m	0.520	0.647	0.774	0.901	1.028	1.155	1.282	1.409	1.536	1.790	2.044
m1	0.332	0.397	0.462	0.526	0.590	0.655	0.782	0.846	0.911	1.040	1.169

## HEXAGON NUTS

## AS 1112

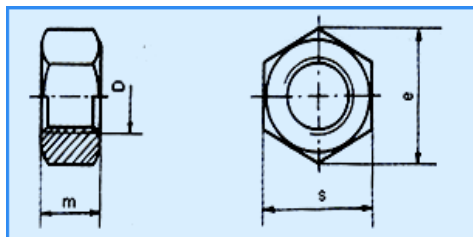

mm

Thread size	M2	M3	M4	M5	M6	M8	M10	M12	M16
Pitch	0.4	0.5	0.7	0.8	1.0	1.25	1.5	1.75	2.0
s	1.6	2.4	3.2	4.7	5.2	6.8	8.4	10.8	14.8
e	4.32	6.01	7.66	8.79	11.05	14.38	17.77	20.03	26.75
s	4	5.5	7	8	10	13	16	18	24
Thread size	M20	M24	M30	M36	M42	M48	M56		
Pitch	2.5	3.0	3.5	4.0	4.5	5.0	5.5		
s	18	21.5	25.6	31	34.8	38.8	45.8		
e	32.95	39.55	50.85	60.79	71.30	82.60	93.50		
s	30	36	46	55	65	75	85		

## HEXAGON NUTS

## ISO 4032

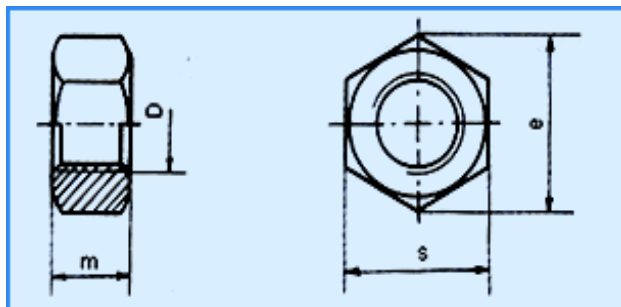

mm

Thread size	M2	M3	M4	M5	M6	M8	M10	M12	M16
Pitch	0.4	0.5	0.7	0.8	1	1.25	1.5	1.75	2
m	1.6	2.4	3.2	4.7	5.2	6.8	8.4	10.8	14.8
e	4.32	6.01	7.66	8.79	11.05	14.38	17.77	20.03	26.75
s	4	5.5	7	8	10	13	16	18	24
Thread size	M20	M24	M30	M36	M42	M48	M56		
Pitch	2.5	3	3.5	4	4.5	5	5.5		
m	18	21.5	25.6	31	34	38	45		
e	32.95	39.55	50.85	60.79	71.3	82.6	93.56		
s	30	36	46	55	65	75	85		

## HEXAGON NUTS

## ISO 4033

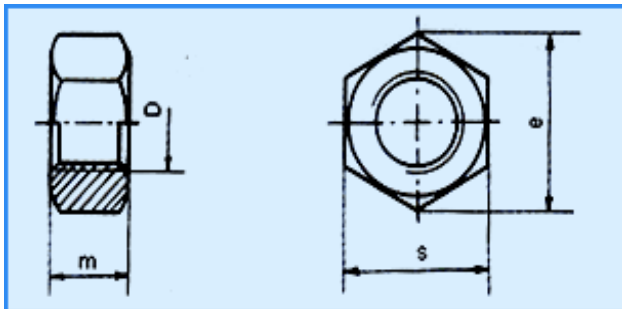

mm

Thread size	M5	M6	M8	M10	M12	M16	M20	M24	M30	M36
Pitch	0.8	1	1.25	1.5	1.75	2	2.5	3	3.5	4
m	5.1	5.7	7.5	9.3	12	16.4	20.3	23.9	28.6	34.7
e	8.79	11.05	14.38	17.77	20.03	26.75	32.95	39.55	50.85	60.79
s	8	10	13	16	18	24	30	36	46	55

## HEXAGON NUTS

## ISO 4034

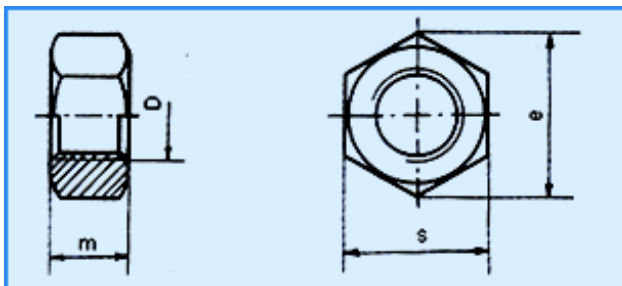

mm

Thread size	M5	M6	M8	M10	M12	M16	M20	M24	M30	M36
Pitch	0.8	1	1.25	1.5	1.75	2	2.5	3	3.5	4
m	5.6	6.1	7.9	9.5	12.2	15.9	19	22.3	26.4	31.5
e	8.63	10.89	14.20	17.59	19.85	26.17	32.95	39.55	50.85	60.79
s	8	10	13	16	18	24	30	35	45	53.8

## HEXAGON THIN NUTS

## ISO 4035

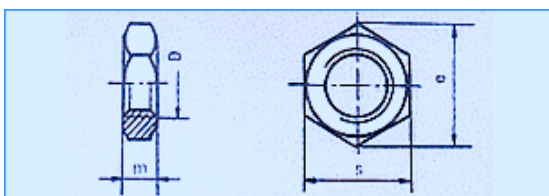

mm

Thread size	M10	M12	M14	M22
Pitch	1.5	1.75	2	2.5
m	5	6	7	11
e	17.77	20.03	23.35	37.29
s	16	18	21	24

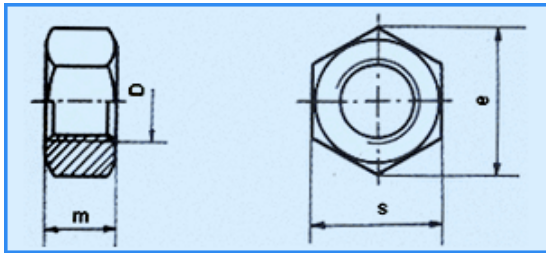
**HEXAGON NUTS****UNI 5587**

Thread size	M3	M4	M5	M6	M8	M10	M12	M16	M20	M24	M30
m	3	4	5	6	8	10	12	16	20	24	30
e	6.08	7.74	8.87	11.05	14.38	18.90	21.10	26.75	33.53	39.98	51.29
s	5.5	7	8	10	13	17	19	24	30	36	46

mm

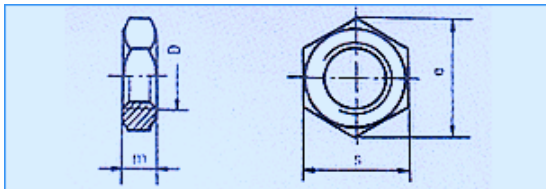
**CHAMFERED HEXAGON THIN NUTS****DIN 439**

Thread size	M3	M4	M5	M6	M8	M10	M12	M16	M20	M24	M30	M36	M42	M48
Pitch	0.5	0.7	0.8	1	1.25	1.5	1.75	2	2.5	3	3.5	4	4.5	5
m	1.8	2.2	2.7	3.2	4	5	6	8	10	12	15	18	21	24
e	6.01	7.66	8.79	11.05	14.38	18.9	21.1	26.75	32.95	39.55	50.85	60.79	71.3	82.6
s	5.5	7	8	10	13	17	19	24	30	36	46	55	65	75

mm

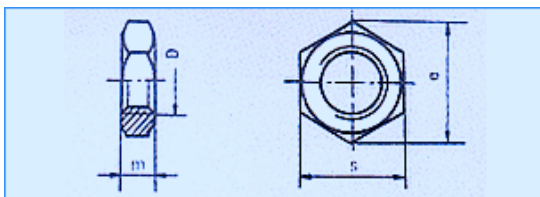
**HEXAGON THIN NUTS****DIN 936**

Thread size	M8	M10	M12	M16	M20	M24	M30	M36	M42	M48
Pitch	1.25	1.5	1.75	2	2.5	3	3.5	4	4.5	5
m	5	6	7	8	9	10	12	14	16	18
e	14.38	18.90	21.1	26.75	32.95	39.55	50.85	60.79	71.3	82.6
s	13	17	19	24	30	36	46	55	65	75

mm

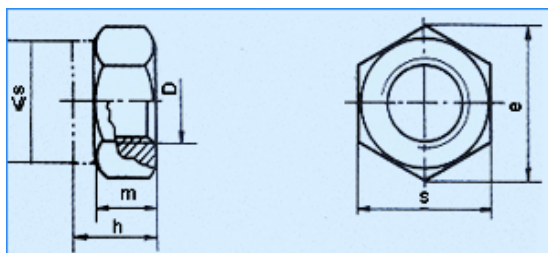
**ALL-METAL PREVALLING TORQUE TYPE HEXAGON NUTS**
**DIN 980**

mm

Thread size	M5	M6	M8	M10	M12	M14	M16	M18	M20
Pitch	0.8	1	1.25	1.5	1.75	2	2	2.5	2.5
h	5.1	6	8	10	12	14	16	18	20
e	8.79	11.05	14.38	18.9	21.1	24.49	26.75	29.56	32.95
s	8	10	13	17	19	22	24	27	30

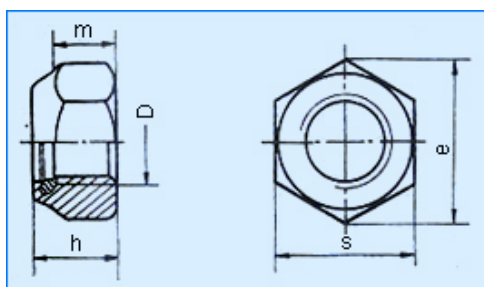
**PREVALLING TORQUE TYPE  
HEXAGON THIN NUTS WITH NONMETALLIC INSERT**
**DIN 985**

mm

Thread size	M5	M6	M8	M10	M12	M14	M16	M18	M20
Pitch	0.8	1	1.25	1.5	1.75	2	2	2.5	2.5
h	5	6	8	10	12	14	16	18.5	20
m	3.2	4	5.5	6.5	8	9.5	10.5	13	14
e	8.79	11.05	14.38	18.9	21.1	24.49	26.75	29.56	32.95
s	8	10	13	17	19	22	24	27	30

**HEX CONNECTING NUTS**
**DIN 6334**

Thread size	M6	M8	M10	M12	M16
-------------	----	----	-----	-----	-----

## HEXAGON WELD NUTS

## DIN 929

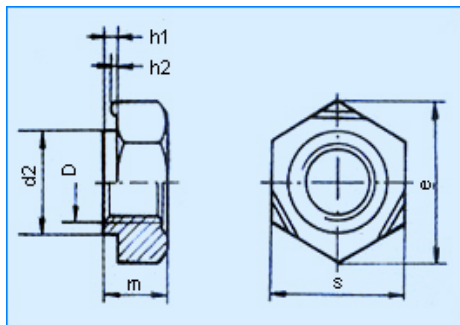

mm

Thread size	M4	M5	M6	M8	M10	M12	M16
m	3.5	4	5	6.5	8	10	13
e	9.83	10.95	12.02	15.38	18.74	20.91	26.51
s	9	10	11	14	17	19	24
h <sub>1</sub>	0.65	0.7	0.75	0.9	1.15	1.4	1.8
h <sub>2</sub>	0.35	0.4	0.4	0.5	0.65	0.8	1
d <sub>2</sub>	6	7	8	10.5	12.5	14.8	18.8

## HEXAGON NUTS WITH FLANGE

## DIN 6923

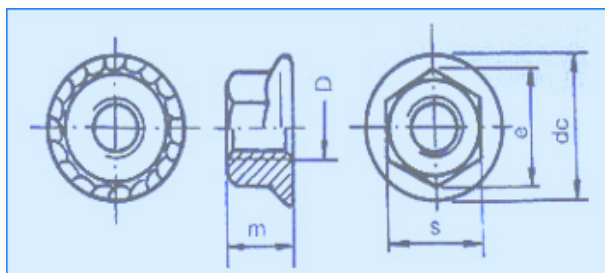

mm

Thread size	M5	M6	M8	M10	M12	M14	M16	M20
Pitch	0.8	1	1.25	1.5	1.75	2	2	2.5
m	5	6	8	10	12	14	16	20
e	8.79	11.05	14.38	16.64	20.03	23.36	26.75	32.95
s	8	10	13	15	18	21	24	30
dc	11.8	14.2	17.9	21.8	26	29.9	34.5	42.8



## HEXAGON SLOTTED NUTS

## DIN 935

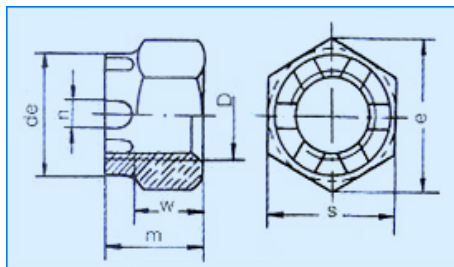

mm

Thread size	M6	M8	M10	M12	M16	M20	M24	M30	M36
m	7.5	9.5	12	15	19	22	27	33	38
e	11.05	14.38	17.77	20.03	26.75	32.95	39.55	50.85	60.79
s	10	13	16	18	24	30	36	46	55
n	2	2.5	2.8	3.5	4.5	4.5	5.5	7	7
w	5	6.5	8	10	13	16	19	24	29
de	-	-	-	16	22	28	34	42	50

## HEXAGON THIN SLOTTED NUTS

## DIN 937

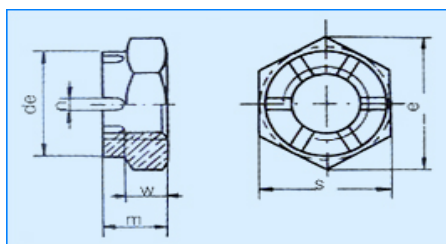

mm

Thread size	M6	M8	M10	M12	M16	M20	M24	M30	M36
m	6	8	9	10	12	13	15	18	20
e	11.05	14.38	18.9	20.1	26.75	32.95	35.55	50.85	60.79
s	10	13	17	19	24	30	36	46	55
n	2	2.5	2.8	3.5	4.5	4.5	5.5	7	7
w	3.5	4.5	5	6	7	8	9	11	13
de	-	-	-	17	22	28	33	41	49

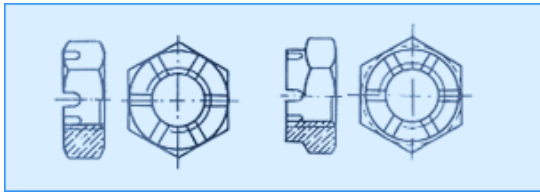
**HEXAGON THIN SLOTTED NUTS****DIN 979**

mm

Thread size	M6	M8	M10	M12	M16	M20	M24	M30	M36
m	5	6.5	8	10	13	16	19	24	29
e	11.05	14.38	17.77	20.03	26.75	32.95	39.55	50.85	60.79
s	10	13	16	18	24	30	36	46	55
n	2	2.5	2.8	3.5	4.5	4.5	5.5	7	7
w	2.5	3.5	4	5	7	10	11	15	20
de	-	-	-	16	22	28	34	42	50

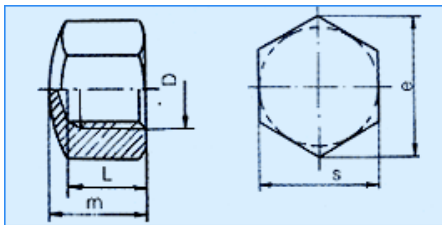
**HEXAGON CAP NUTS****DIN 917**

mm

Thread size	M4	M5	M6	M8	M10	M12	M16	M20	M24
m	5.5	7	9	12	14	16	20	25	30
e	7.66	8.79	11.05	14.38	17.77	20.03	26.75	32.95	39.55
s	7	8	10	13	16	18	24	30	36
L	4.16	4.96	6.71	9.21	10.65	13.15	16.65	20.58	23.58

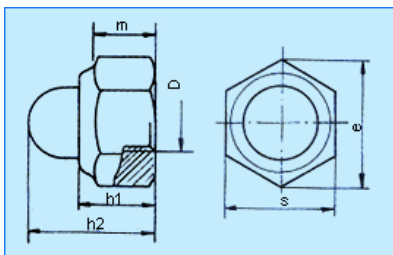
**HEXAGON DOMED CAP NUTS****DIN 986**

mm

Thread size	M4	M5	M6	M8	M10	M12	M16	M20
m	2.9	4.4	4.9	6.44	8.04	10.37	14.1	16.9
e	7.66	8.79	11.05	14.38	18.9	21.1	26.75	32.95
s	7	8	10	13	16	18	24	30
h <sub>1</sub>	5.6	6	7.5	8.9	10.5	13.5	16.5	21
h <sub>2</sub>	9.6	10.5	12	14	18.1	22.5	27.5	35

## HEXAGON DOMED CAP NUTS

## DIN 1587

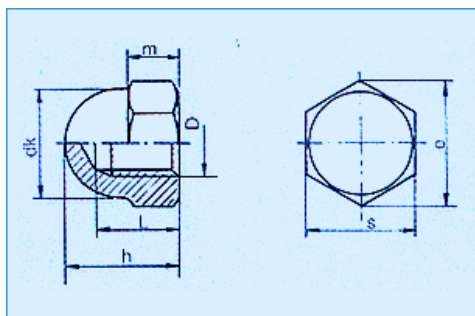

Thread size	M4	M5	M6	M8	M10	M12	M16	M20	M24
m	3.2	4	5	6.5	8	10	13	16	19
e	7.66	8.79	11.05	14.38	17.77	20.03	26.75	33.53	39.98
s	7	8	10	13	16	18	24	30	36
h	8	10	12	15	18	22	28	34	42
L	5.26	7.21	7.71	10.65	12.65	15.65	20.58	25.58	30.5
dk	6.5	7.5	9.5	12.5	15	17	23	28	34

mm

## WING NUTS

## DIN 315

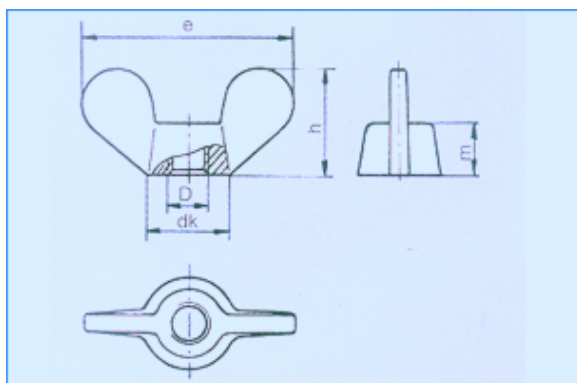

Thread size	M4	M5	M6	M8	M10	M12	M16	M20	M24
Pitch	0.7	0.8	1	1.25	1.15	1.75	2	2.5	3
dk	6	8	10	13	17	20	26	32	41
e	18	24	30	36	48	62	70	86	106
h	8.5	11	15	18	23	31	35	44	53.5
m	3.2	4	5	6.5	8	10	13	16	20

mm

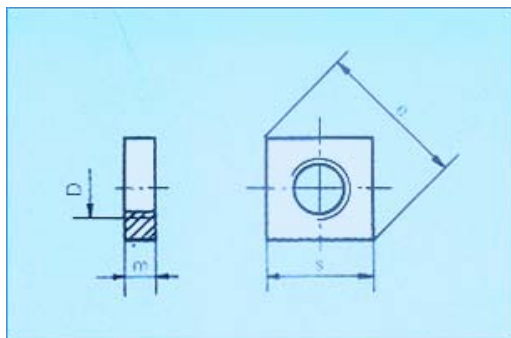
**SQUARE THIN NUTS**
**DIN 562**

Thread size	M2	M3	M4	M5	M6	M8	M10	
Pitch	0.4	0.5	0.7	0.8	1	1.25	1.5	
m	1.2	1.8	2.2	2.7	3.2	4	5	
e	5	7	8.9	10.2	12.7	16.5	20.2	21.5
s	4	5.5	7	8	10	13	16	17

mm

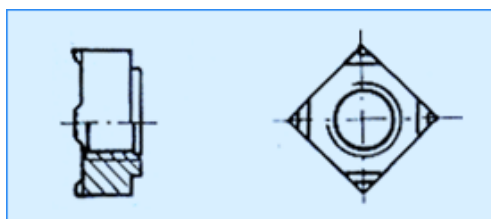
**SQUARE NUTS**
**DIN 928**

Thread size	M4	M5	M6	M8	M10	M12
-------------	----	----	----	----	-----	-----

mm

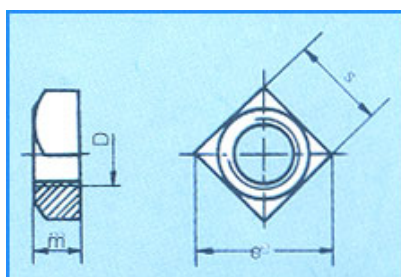
**SQUARE NUTS**
**DIN 557**

Thread size	M5	M6	M8	M10	M12	M16	M20		
Pitch	0.8	1	1.25	1.5	1.75	2	2.5		
m	4	5	6.5	8	10	13	16		
e	11.3	14.1	18.4	22.6	24	25.4	26.9	32.9	42.4
s	8	10	13	16	17	18	19	24	30

mm

## SQUARE NUTS

B.S.

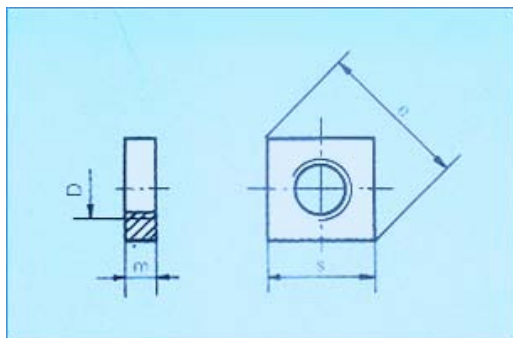

Thread size	1/8	5/32	3/16	1/4
Thread per inch	40	32	24	20
m	2.13	2.74	3.12	3.38
e	7.9	10.1	11.6	15.9
s	5.59	7.16	8.23	11.30

inches

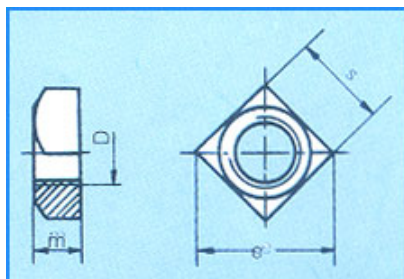

Thread size	3/16	1/4	5/16	3/8	7/16	1/2
Thread per inch	24	20	18	16	14	12
m	4.24	5.08	6.35	7.92	9.53	11.10
e	11.6	15.9	18.9	21.5	25.4	29.4
s	8.23	11.3	13.34	15.24	18.03	20.83

inches

## TEE NUTS WITH PRONGES

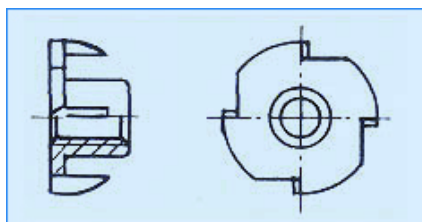

Thread size	M3	M4	M5	M6	M8	M10
-------------	----	----	----	----	----	-----

## LOCK NUTS

## DIN 7967



For thread	M3	M4	M5	M6	M8	M10	M12	M14	M16	M18
For thread	M20	M22	M24	M27	M30	M33	M36	M39	M42	

## LOCK NUTS

## DIN 582

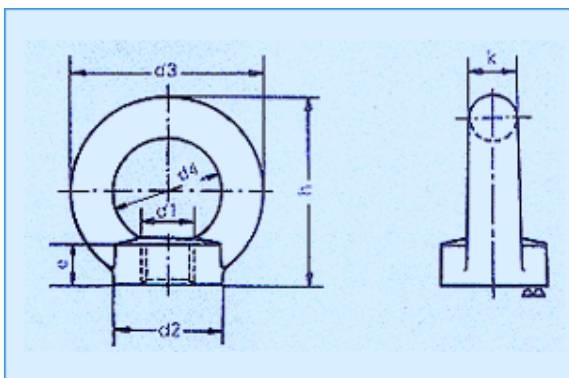

	mm							
d1	M8	M10	M12	M16	M20	M24	M30	M36
d2	20	25	30	35	40	50	65	75
d3	36	45	54	63	72	90	108	126
d4	20	25	30	35	40	50	60	70
e	8.5	10	11	13	16	20	25	30
h	36	45	53	62	71	90	109	128
k	8	10	12	14	16	20	24	28

## EYE COUPLING NUTS

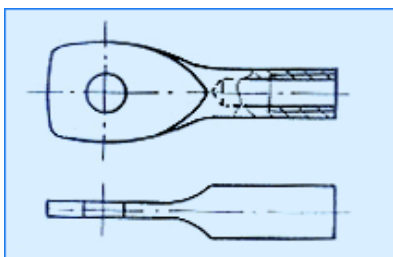

Thread size	M6
-------------	----

## ANCHOR NUTS

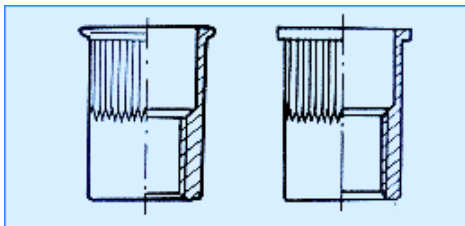

Thread size	M3	M4	M5	M6	M8	M10
-------------	----	----	----	----	----	-----

## WASHERS

### WASHERS (Grade A)

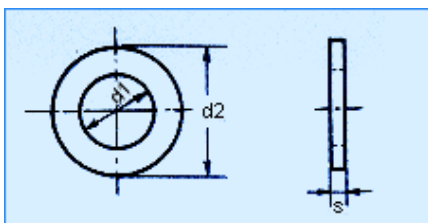
**DIN 125**

	mm										
d1	1.7	1.8	2.2	2.5	2.7	2.8	3.2	3.7	4.3	5.3	6.4
d2	4	4.5	5	6	6	7	7	8	9	10	12
s	0.3	0.3	0.3	0.5	0.5	0.5	0.5	0.5	0.8	1	1.6
d1	7.4	8.4	10.5	13	15	17	19	21	23	23	
d2	14	16	20	24	28	30	34	37	39	39	
s	1.6	1.6	2	2.5	2.5	3	3	3	3	3	

### WASHERS (Grade C)

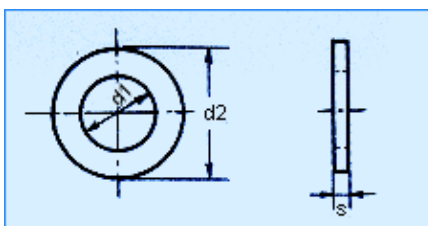
**DIN 126**

	mm										
d1	5.5	6.6	7.6	9	11	13.5	15.5	17.5	20	22	24
d2	10	12.5	14	16	20	24	28	30	34	37	39
s	1	1.6	1.6	1.6	2	2.5	2.5	3	3	3	3
d1	26	30	33	36	39	42	45	48	52	56	
d2	44	50	56	60	66	72	78	85	92	98	
s	4	4	4	5	5	6	7	7	8	8	

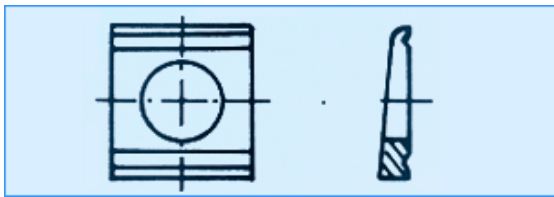
**SQUARE BEVELED WASHERS****DIN 434**

For screws M8 M10 M12 M16 M20 M22 M24 M27

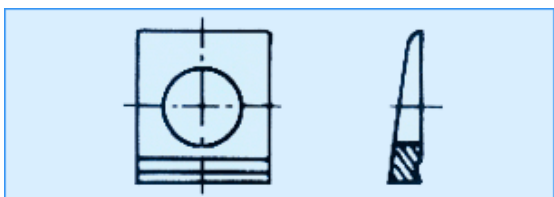
**SQUARE BEVELED WASHERS****DIN 435**

For screws M8 M10 M12 M16 M20 M22 M24 M27 M30

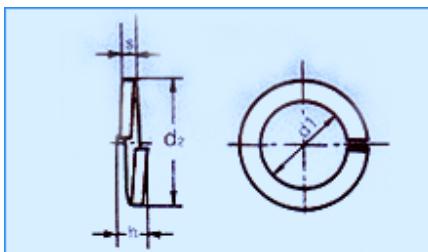
**SPRING LOCK WASHERS****DIN 127**

	mm									
Nominal size	3	3.5	4	5	6	7	8	10	12	
d1	3.4	3.9	4.4	5.4	6.5	7.5	8.5	10.7	12.7	
d2	6.2	6.7	7.6	9.2	11.8	12.8	14.8	18.1	21.1	
h	1.9	1.9	2.1	2.8	3.8	3.8	4.7	5.2	5.9	
s	0.8	0.8	0.9	1.2	1.6	1.6	2	2.2	2.5	
Nominal size	14	16	18	20	22	24	27	30		
d1	14.7	17	19	21.2	23.5	25.5	28.5	31.7		
d2	24.1	27.4	29.4	33.6	35.9	40	43	48.2		
h	7.1	8.3	8.3	9.4	9.4	11.8	11.8	14.2		
s	3	3.5	3.5	4	4	5	5	6		





**SPRING LOCK WASHERS**

**B.S.**

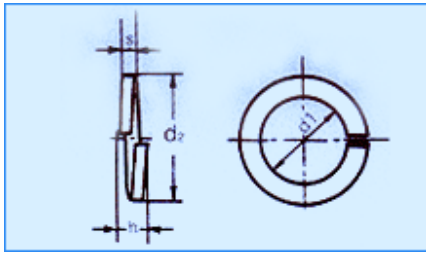

inches

Nominal	1/8	5/32	3/16	1/4	5/16	3/8	7/16	1/2	9/16
d1	0.133	0.164	0.196	0.266	0.328	0.391	0.453	0.516	0.601
b	0.053	0.061	0.075	0.108	0.130	0.142	0.161	0.173	0.189
h	0.067	0.083	0.098	0.142	0.165	0.189	0.220	0.244	0.283
s	0.033	0.041	0.049	0.071	0.083	0.094	0.110	0.122	0.142
Nominal	5/8	3/4	7/8	1	1 1/8	1 1/4	1 1/2		
d1	0.656	0.781	0.906	1.031	1.156	1.281	1.531		
b	0.213	0.248	0.276	0.291	0.307	0.331	0.354		
h	0.303	0.354	0.394	0.433	0.472	0.504	0.551		
s	0.152	0.177	0.197	0.217	0.236	0.252	0.276		

**MACHINE SCREWS**

**GALVANIZED ROOFING BOLTS & NUTS**

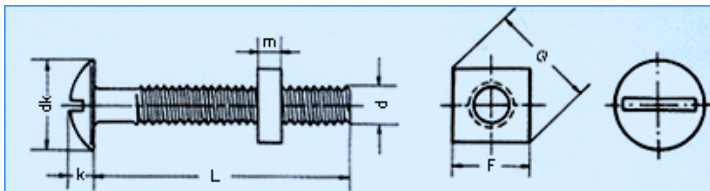

inches

Thread size	dk	k	m	F	G	L
3/6	10	2.3	3.048	8.128	11.684	3/16-3
1/4	13.3	3	0.302	11.176	16.002	1/2-5

**SLOTTED CHEESE HEAD SCREWS**

**DIN 84**

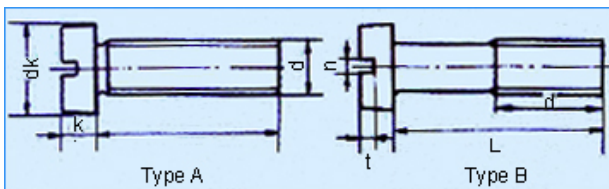

mm

Thread size	M3	M3.5	M4	M5	M6	M8	M10
dk	5.5	6	7	8.5	10	13	16
k	2	2.4	2.6	3.3	3.9	5	6
L	A	6-22	6-22	8-25	8-28	10-35	14-40
	B	25-30	25-35	28-40	30-50	40-60	45-80

## SLOTTED PAN HEAD SCREWS

DIN 85

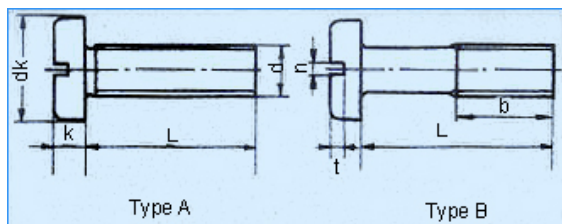

mm

Thread size	M3	M3.5	M4	M5	M6	M8	M10
dk	6	7	8	10	12	16	20
k	1.8	2.1	2.4	3	3.6	4.8	6
L	A	6-22	6-22	8-25	8-28	10-35	14-40
	B	25-30	25-35	28-40	30-50	40-60	45-80

## SLOTTED COUNTERSUNK HEAD SCREWS

DIN 963

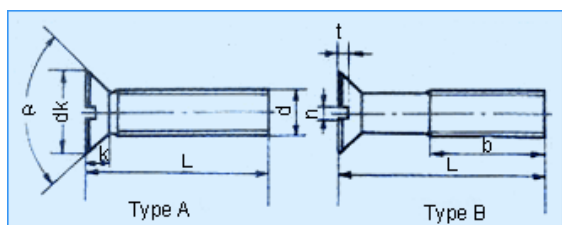

mm

Thread size	M3	M3.5	M4	M5	M6	M8	M10
dk	5.6	6.5	7.5	9.2	11	14.5	18
k	1.65	1.93	2.2	2.5	3	4	5
L	A	6-22	6-22	8-25	8-28	10-35	14-40
	B	25-30	25-35	28-40	30-50	40-60	45-80

## SLOTTED RAISED COUNTERSUNK HEAD SCREWS

DIN 964

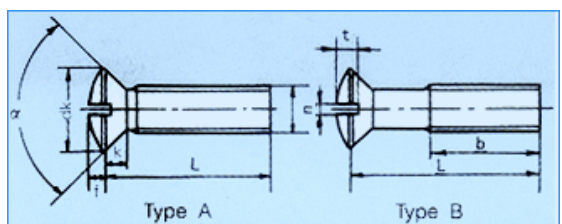

mm

Thread size	M3	M3.5	M4	M5	M6	M8	M10
dk	5.6	6.5	7.5	9.2	11	14.5	18
k	1.65	1.93	2.2	2.5	3	4	5
f	0.75	0.9	1	1.25	1.5	2	2.5
L	A	6-22	6-22	8-25	8-28	10-35	14-40
	B	25-30	25-35	28-40	30-50	40-60	45-80

## ROOFING BOLTS & NUTS

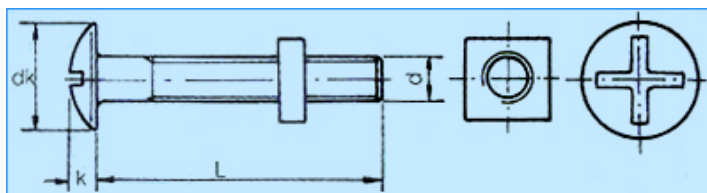

mm

Thread size	M4	M5	M6	M8
dk	9.4	11.6	13.95	18.9
k	1.90	2.65	3.33	3.80
L	10-50	10-80	12-120	16-150

## CROSS RECESSED RAISED CHEESE HEAD SCREWS

DIN 7985

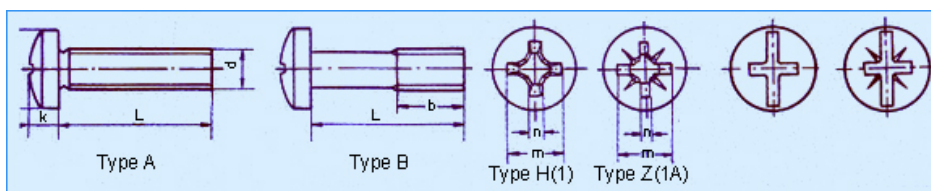

mm

Thread size	M3	M3.5	M4	M5	M6	M8	M10
dk	6	7	8	10	12	16	20
k	2.4	2.7	3.1	3.8	4.6	6	7.5
Cross recessed	(Type H)m	3.1	4.2	4.6	5.3	6.8	10.2
	(Type Z)m	3	4	4.3	5	6.7	9.9
	No	1	2	2	2	3	4
L	Type A	6-22	6-22	8-25	8-28	10-35	14-40
	Type B	25-30	25-35	28-40	30-50	40-60	45-80

## CROSS RECESSED COUNTERSUNK FLAT HEAD SCREWS

DIN 965

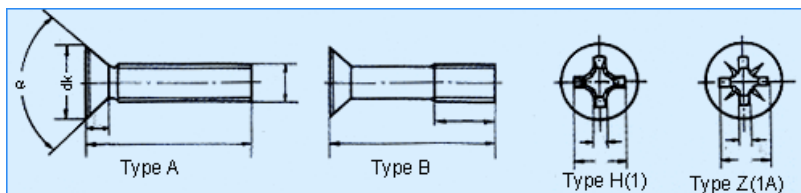

mm

Thread size	M3	M3.5	M4	M5	M6	M8	M10
dk	5.6	6.5	7.5	9.2	11	14.5	18
k	1.65	1.93	2.2	2.5	3	4	5
Cross recessed	(Type H)m	2.9	3.9	4.4	4.6	6.6	9.6
	(Type Z)m	2.8	3.7	4	4.4	6.1	9.4
	No	1	2	2	2	3	4
L	Type A	6-22	6-22	8-25	8-28	10-35	14-40
	Type B	25-30	25-35	28-40	30-50	40-60	45-80

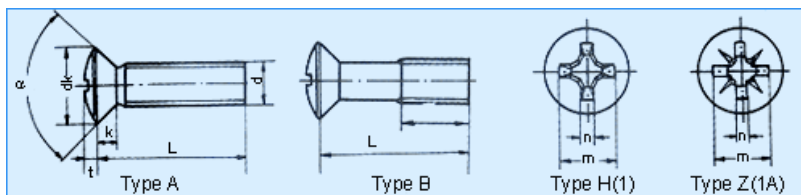
**CROSS RECESSED RAISED COUNTERSUNK HEAD SCREWS**
**DIN 966**

		mm						
Thread size		M3	M3.5	M4	M5	M6	M8	M10
dk		5.6	6.5	7.5	9.2	11	14.5	18
k		1.65	1.93	2.2	2.5	3	4	5
f		0.75	0.9	1	1.25	1.5	2	2.5
Cross	(Type H)m	3.1	4.2	4.5	5.3	6.8	9	10
	(Type Z)m	3.1	4.3	4.6	5.3	7	8.8	9.9
NO		1	2	2	2	3	4	4
L	Type A	6-22	6-22	8-25	8-28	10-35	14-40	18-45
	Type B	25-30	25-35	28-40	30-50	40-60	45-80	50-100

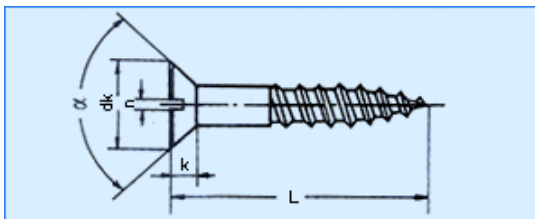
**WOOD SCREWS**
**SLOTTED COUNTERSUNK HEAD WOOD SCREWS**
**DIN 97**

		mm							
Thread size	2.5	3	3.5	4	4.5	5	5.5	6	
dk	4.7	5.6	6.5	7.5	8.3	9.2	10.2	11	
k	1.5	1.65	1.93	2.2	2.35	2.5	2.75	3	
n	0.6	0.8	0.8	1	1	1.2	1.2	1.6	
L	8-25	10-40	12-40	16-50	20-60	20-100	30-100	40-100	

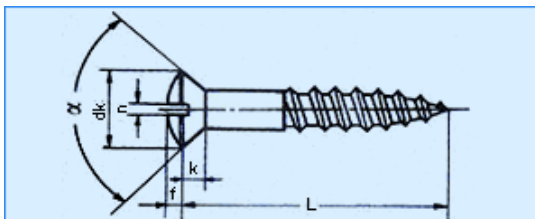
**SLOTTED RAISED COUNTERSUNK HEAD WOOD SCREWS**
**DIN 95**

		mm							
Thread size	2.5	3	3.5	4	4.5	5	5.5	6	
dk	4.7	5.6	6.5	7.5	8.3	9.2	10.2	11	
f	0.6	0.75	0.9	1	1.1	1.25	1.4	1.5	
k	1.5	1.65	1.93	2.2	2.35	2.5	2.75	3	
n	0.6	0.8	0.8	1	1	1.2	1.2	1.6	
L	8-25	10-40	12-40	16-50	20-60	20-100	30-100	40-100	

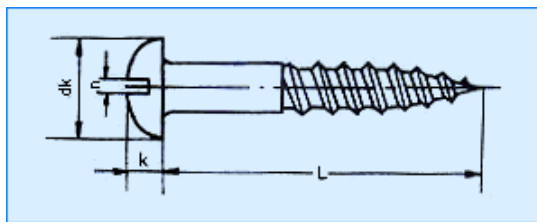
**SLOTTED ROUND HEAD WOOD SCREWS**
**DIN 96**

Thread size	2.5	3	3.5	4	4.5	5	5.5	6
dk	5	6	7	8	9	10	11	12
K	1.7	2.1	2.4	2.8	3.1	3.5	3.8	4.2
n	0.6	0.8	0.8	1	1	1.2	1.2	1.6
L	8-25	10-40	12-40	16-50	20-60	20-100	30-100	40-100

mm

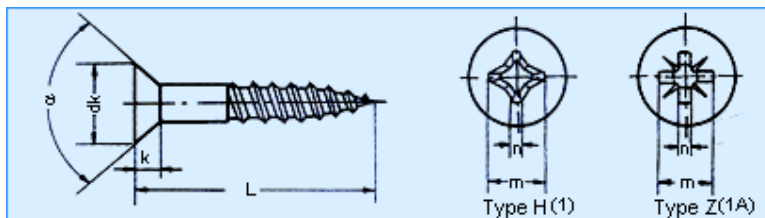
**FLAT COUNTERSUNK HEAD WOOD SCREWS**
**DIN 7997**

Thread size	2.5	3	3.5	4	4.5	5	5.5	6
dk	4.7	5.6	6.5	7.5	8.3	9.2	10.2	11
k	1.5	1.65	1.93	2.2	2.35	2.5	2.75	3
Cross recess	(Type H) m	2.7	2.9	3.9	4.4	4.6	4.8	6.2
	(Type Z) m	2.8	3	4	4.2	4.4	5	6.1
	No	1	1	2	2	2	3	3
L	10-25	10-40	12-45	16-50	20-60	20-100	30-100	40-100

mm

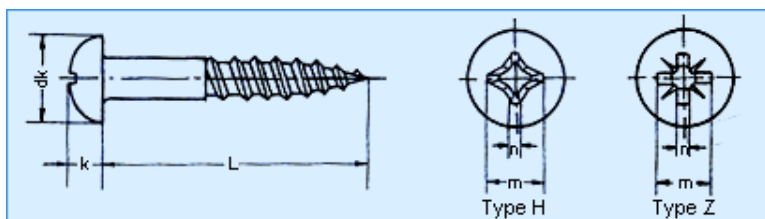
**CROSS RECESSED ROUND HEAD WOOD SCREWS**
**DIN 7996**

Thread size	2.5	3	3.5	4	4.5	5	5.5	6
dk	5	6	7	8	9	10	11	12
k	1.7	2.1	2.35	2.8	3.1	3.5	3.8	4.2
Cross	(Type H) m	2.3	2.7	3.7	4.1	4.4	4.8	6.2
	(Type Z) m	2.4	2.9	3.9	4.1	4.3	4.7	6.2
	No	1	1	2	2	2	2	3
L	10-25	10-40	12-40	16-50	20-60	20-100	30-100	40-100

mm

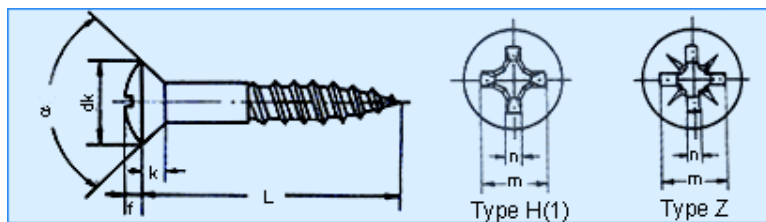
**CROSS RECESSED RAISED COUNTERSUNK HEAD WOOD SCREWS**
**DIN 7995**

mm

Thread size	2.5	3	3.5	4	4.5	5	5.5	6
dk	4.7	5.6	6.5	7.5	8.3	9.2	10.2	11
f	0.6	0.75	0.9	1	1.1	1.25	1.4	1.5
k	1.5	1.65	1.93	2.2	2.35	2.5	2.75	3
Cross	(Type H) m	2.7	3.1	4.2	4.5	5	5.3	7.4
	(Type Z) m	2.8	3.1	4.3	4.6	5.1	5.3	6.6
	No	1	1	2	2	2	3	3
L	10-25	10-40	12-40	16-50	20-60	20-100	30-100	40-100

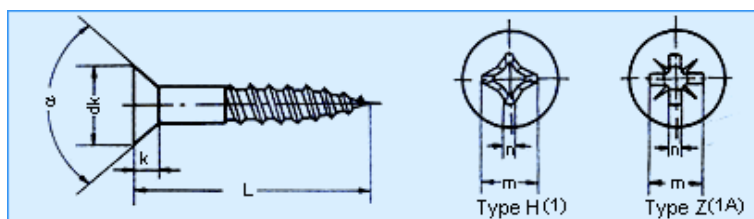
**PHILLIPS OVAL HEAD WOOD SCREWS**
**B.S. 1210**

inches

Thread size	4	5	6	7	8	9	10
dk	5.21	5.90	6.58	7.24	7.93	8.59	9.28
f	0.66	0.76	0.81	0.91	1.02	1.17	1.19
k	1.62	1.85	2.08	2.31	2.54	2.76	2.97
Cross recess	(Type Z) m	3.12	3.81	4.32	4.65	5.00	5.28
	NO	1	1	2	2	2	2
L	1/2-1	1/2-1 1/4	1/2-2	3/4-2	3/4-3	3/4-3	3/4-3 1/2

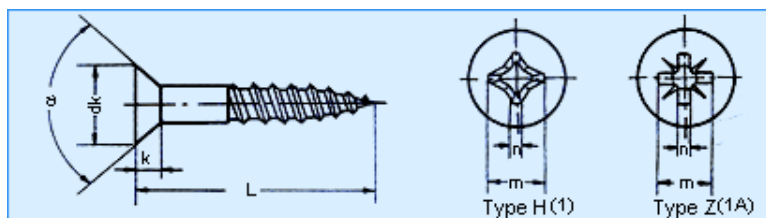
**CROSS RECESSED COUNTERSUNK HEAD WOOD SCREWS**
**B.S. 1210**

inches

Thread size	3	4	5	6	7	8	9	10	12	14	16
dk	4.55	5.21	5.90	6.56	7.24	7.93	8.59	9.28	10.62	11.99	13.31
k	1.39	1.62	1.88	2.08	2.31	2.54	2.76	2.97	3.42	3.88	4.31
(Type Z) m	2.51	2.74	3.50	4.22	4.22	4.60	4.60	4.98	6.35	6.60	7.49
Cross recess	No	1	1	2	2	2	2	2	3	3	3
	L	1/2-5/8	1/2-2	1/2-1 1/4	1/2-2	3/4-2	3/4-3	3/4-3	3/4-3 1/2	1-5	1 1/2-5

## EURO SCREW

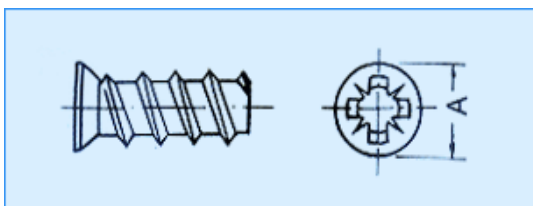

	mm	
Nominal size	6.3	6.3
Length	9-13	9-13
A	7	8

## CONNECTING SCREW FLAT COUNTERSUNK HEAD

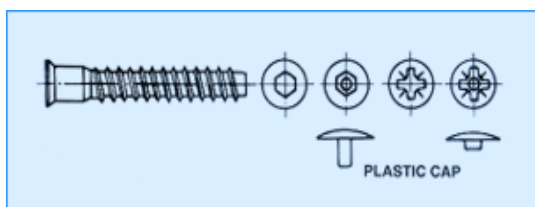

	mm		
Nominal size	5	7	6.3
Length	40-60	40-80	40-80

## JOINT CONNECTOR SCREW FLAT HEAD

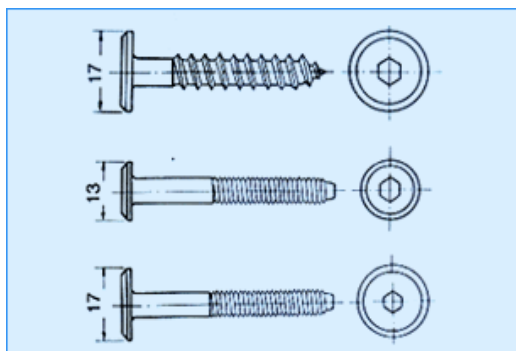

Nominal size	M6-1.0	1/4-20	6.3
Length	20-120	20-120	20-120



### JOINT CONNECTOR SCREW ROUND HEAD

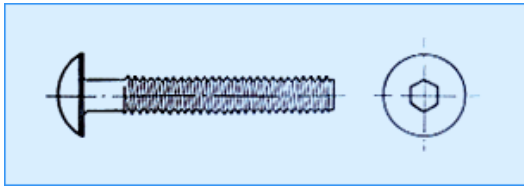

Nominal size	M6-1.0	1/4-20
Length	20-120	20-120

### HEXAGON HEAD WOOD SCREWS

DIN 571

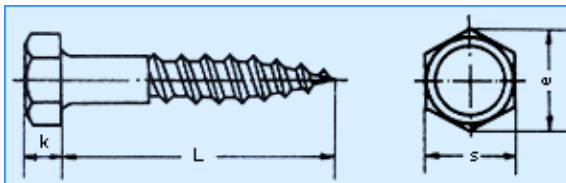

Thread size	4	5	6	7	8	10	12	16
k	2.8	3.5	4	5	5.5	7	8	10
e	7.50	8.63	10.89	13.07	14.2	18.72	20.88	26.17
s	7	8	10	12	13	17	19	24
L	16-40	16-50	25-150	30-150	30-200	30-300	35-400	50-420

mm

### ACOUSTICALL EYELAGS

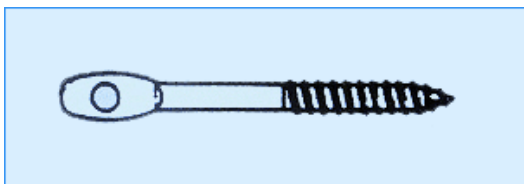

Nominal size	1/4 x 3"	1/4 x 4"	1/4 x 5"

inches

### METAL WOOD DOWEL SCREW

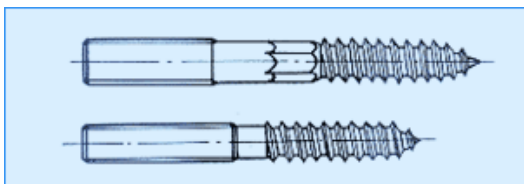

Nominal size	M8-12
Length	50-200

mm





## WOOD-WOOD DOWEL SCREW

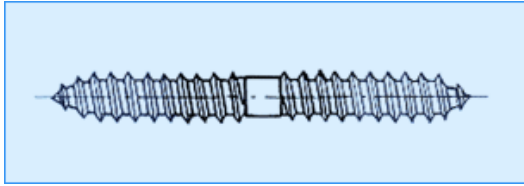

Nominal size	3.5-6.3
Length	25-80

## POZIDRIVE TWINFAST WOOD SCREWS

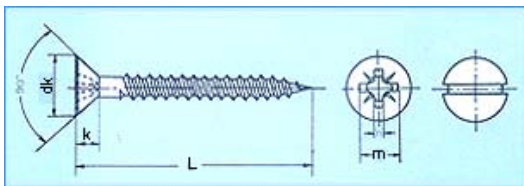

Thread size		4	5	6	7	8	10	12
dk		5.48	6.19	6.90	7.62	8.33	9.75	11.17
k		1.66	1.90	2.13	2.36	2.53	3.01	3.44
n		0.86	1.06	1.06	1.06	1.26	1.26	1.66
cross recess	No	1	2	2	2	2	2	3
	m	2.74	3.50	4.22	4.22	4.60	4.98	6.35
L(in)		1/4-1	5/16-11/4	7/16-2	1/2-21/4	5/8-3	3/4-4	1-4

mm

## TAPPING AND CHIPBOARD

### PAN HEAD TAPPING SCREWS WITH SLOT

DIN 7971

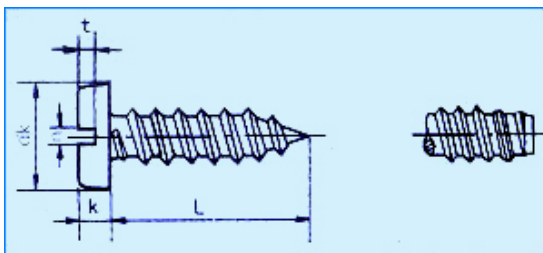

Thread size	2.9	3.5	3.9	4.2	4.8	5.5	6.3
dk	5.6	6.9	7.5	8.2	9.5	10.8	12.5
k	1.5	1.85	2	2.15	2.5	2.85	3.2
m	0.8	1	1	1.2	1.2	1.6	1.6
L(mm)	6.5-25	6.5-50	9.5-50	9.5-63	9.5-63	13-75	13-75

mm

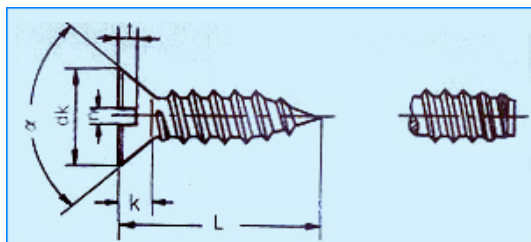
**COUNTERSUNK HEAD TAPPING SCREWS WITH SLOT**
**DIN 7972**

mm

Thread size	2.9	3.5	3.9	4.2	4.8	5.5	6.3
dk	5.5	6.8	7.5	8.1	9.5	10.8	12.4
k	1.7	2.1	2.3	2.5	3	3.4	3.8
n	0.8	1	1	1.2	1.2	1.6	1.6
L	6.5-25	6.5-50	9.5-50	9.5-63	9.5-63	13-75	13-75

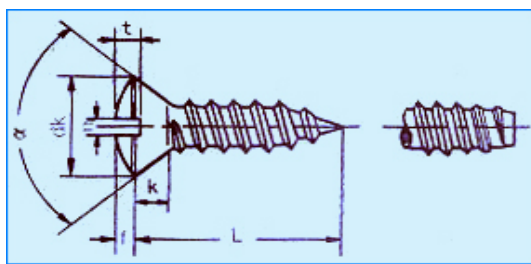
**RAISED COUNTERSUNK HEAD TAPPING SCREWS WITH SLOT**
**DIN 7973**

mm

Thread size	2.9	3.5	3.9	4.2	4.8	5.5	6.3
dk	5.5	6.8	7.5	8.1	9.5	10.8	12.5
f	0.9	1.2	1.3	1.4	1.5	1.7	2
k	1.7	2.1	2.3	2.5	3	3.4	3.8
n	0.8	1	1	1.2	1.2	1.6	1.6
L	6.5-25	6.5-50	9.5-50	9.5-63	9.5-63	13-75	13-75

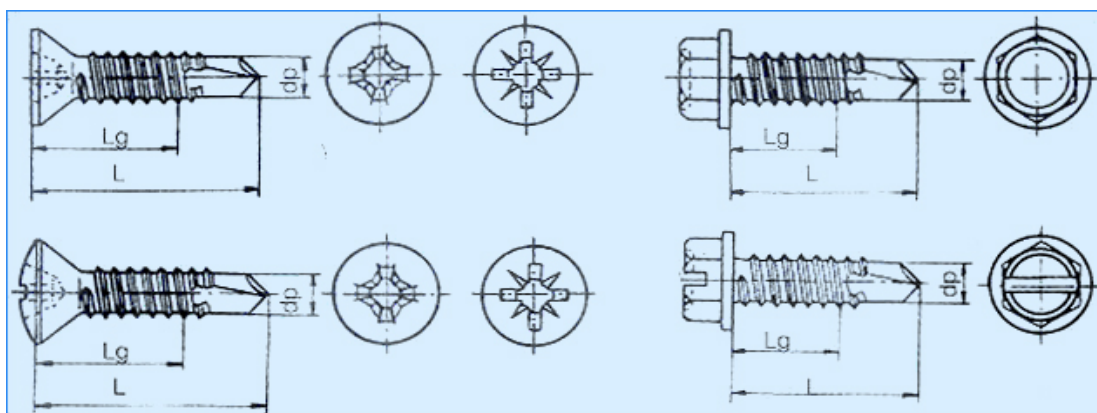
**SELF-DRILLING TAPPING SCREWS**
**DIN 7504**

mm

Thread size	ST2.9	ST3.5	ST4.2	ST4.8	ST5.5	ST6.3
dp	2.3	2.8	3.6	4.1	4.8	5.8
Lg	12.5	18.1	29.0	39.5	8-39	7-38
L	6.5-25	6.5-50	9.5-50	9.5-63	13-75	13-75

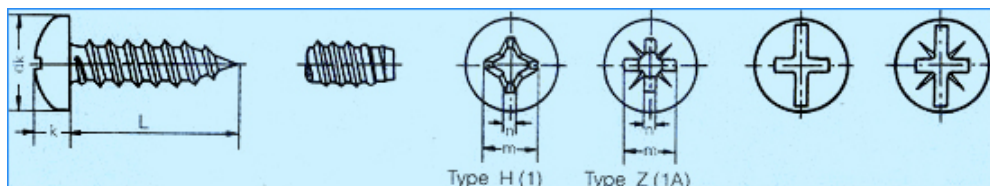
**CROSS RECESSED PAN HEAD TAPPING SCREWS**
**DIN 7981**

mm

Thread size	2.9	3.5	3.9	4.2	4.8	5.5	6.3
Pitch	5.6	6.9	7.5	8.2	9.5	10.8	12.5
k	2.2	2.6	2.8	3.05	1.55	3.95	4.55
Cross recess	(Type H)m	3	4.2	4.4	4.6	5	6.5
	(Type Z)m	2.9	3.9	4.1	4.3	4.7	6.2
	No	1	1	2	2	2	3
L	6.5-25	6.5-50	9.5-50	9.5-63	9.5-63	13-75	13-75

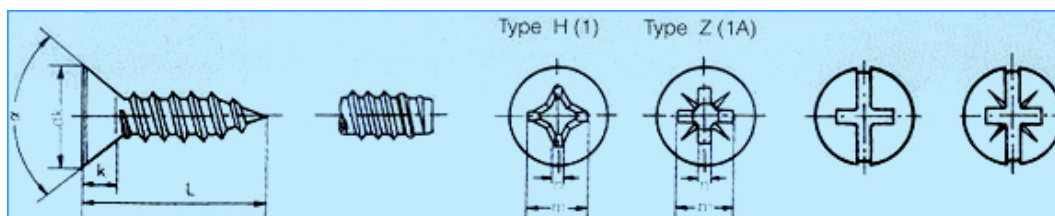
**CROSS RECESSED COUNTERSUNK HEAD TAPPING SCREWS**
**DIN 7982**

mm

Thread size	2.9	3.5	3.9	4.2	4.8	5.5	6.3
dk	5.5	6.8	7.5	8.1	9.5	10.8	12.4
k	1.7	2.1	2.3	2.5	3	3.4	3.8
Cross recess	(Type H) m	3	4.2	4.6	4.7	5.1	5.8
	(Type Z) m	2.8	4	4.2	4.4	5	6.3
	No	1	1	2	2	2	3
L	6.5-25	6.5-50	9.5-50	9.5-63	9.5-63	13-75	13-75

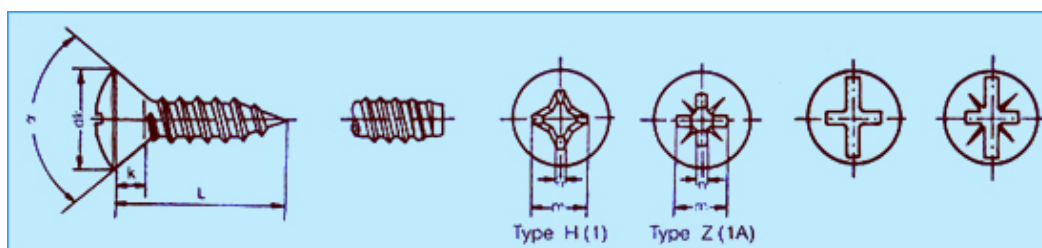
**CROSS RECESSED RAISED COUNTERSUNK HEAD TAPPING SCREWS**
**DIN 7983**

mm

Thread size	2.9	3.5	3.9	4.2	4.8	5.5	6.3
dk	5.5	6.8	7.5	8.1	9.5	10.8	12.4
f	0.9	1.2	1.3	1.4	1.5	1.7	2
k	1.7	2.1	2.3	2.5	3	3.4	3.8
Cross	(Type H) m	3.4	4.6	4.7	4.9	5.4	7
	(Type Z) m	3.1	4.3	4.4	4.6	5.1	6.6
	No	1	1	2	2	2	3
L	6.5-25	6.5-50	9.5-50	9.5-63	9.5-63	13-75	13-75

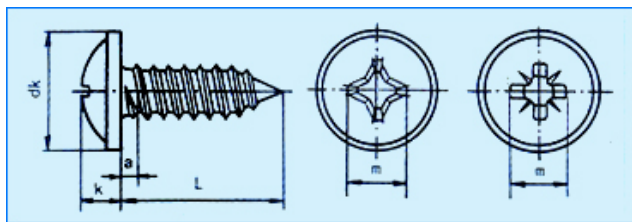
**CROSS RECESSED PAN HEAD TAPPING SCREWS WITH COLLAR**
**DIN 968**

mm

Thread size	ST2.9	ST3.5	ST4.2	ST4.8	ST5.5	ST6.3
dk	7.50	9.00	10.0	11.5	13.0	14.5
k	2.35	2.60	3.05	3.55	3.80	4.55
Cross	(Type H) m	3.00	4.20	4.60	5.00	6.50
	(Type Z) m	2.90	3.90	4.30	4.70	6.20
No	1	2	2	2	3	3
L	6.5-19	9.5-25	9.5-32	9.5-50	13-50	13-50

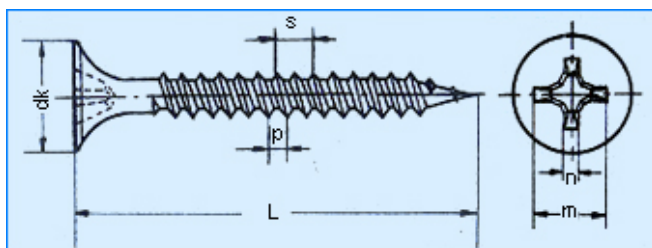
**DRYWALL SCREWS TYPE S PHILLIPS RECESSED BUGLE HEAD TWINFAST**

Thread size	Threads/in	dk	Cross recess		L(in)
			No	m	
6	18	8.4	2	4.9	3/4-2 1/2
7	16	8.4	2	4.9	1-2 1/2
8	15	8.4	2	4.9	2-4

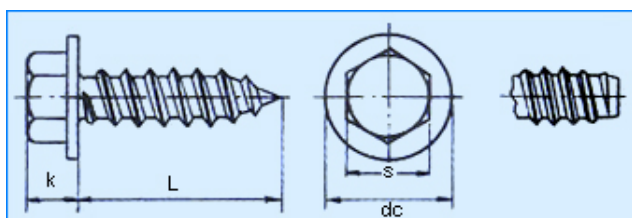
**HEXAGON WASHER HEAD TAPPING SCREWS**
**DIN 6928**

mm

Thread size	ST2.9	ST3.5	ST4.2	ST4.8	ST6.3	ST8.0
dc	6.30	8.30	8.80	10.5	13.5	18.0
k	2.80	3.40	4.0	4.30	5.90	7.00
s	4.00	5.50	7.00	8.00	10.0	13.0
L	6.5-25	6.5-50	9.5-50	9.5-63	13-75	13-75

### FERMACELL SCREWS WITH RIBS UNDER THE HEAD

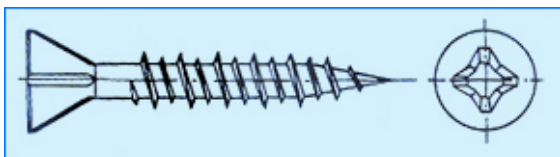

### HEX HEAD TAPPING SCREWS

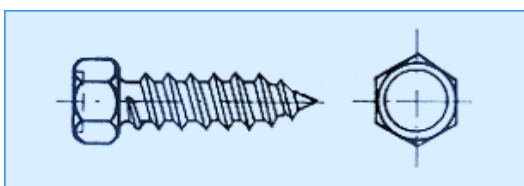

Nominal size	4.2	4.8	5.5	6.3	8 <sup>#</sup>	10 <sup>#</sup>	12 <sup>#</sup>	1/4
Length	9.5-50	13-75	16-100	16-120	3/8-2	1/2-3	3/4-4	3/4-5

### HEX FLANGE HEAD SELF-TAPPING SCREWS

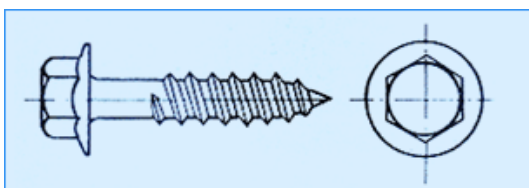

Nominal	5.5	6.3	12 <sup>#</sup>	14 <sup>#</sup>
Length	16-120	16-180	16-120	16-180

### HEX FLANGE HEAD TYPE 17 SCREWS

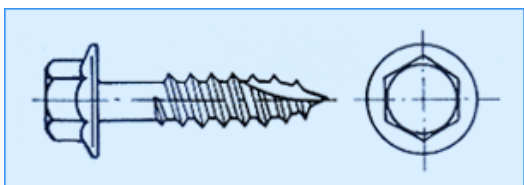

Nominal	12 <sup>#</sup>	1/4	5.5	6.3
Length	1-5	1 1/2-5	25-120	30-120

## PINS, RIVETS AND ANCHORS

### SPLIT PINS

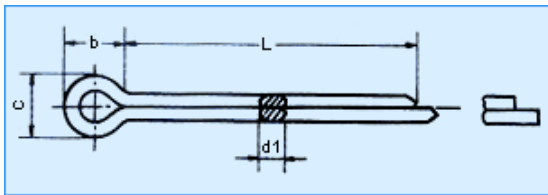
**DIN 94**

Nominal	2	2.5	3.2	4	5	6.3	8	10
d1	1.8	2.3	2.9	3.7	4.6	5.9	7.5	9.5
b	4	5	6.4	8	10	12.6	16	20
c	3.2	4	5.1	6.5	8	10.3	13.1	16.6
L	10-40	12-50	18-80	20-125	20-125	28-140	36-140	56-140

mm

### SPLIT PINS

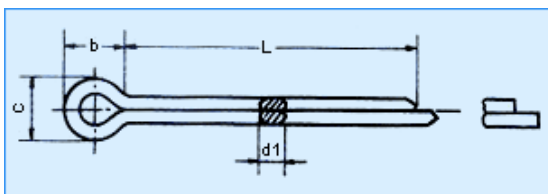
**ISO 1234**

Nominal	1	1.2	1.6	2	2.5	3.2	4	5	6.3	8	10
d1	0.8	0.9	1.3	1.7	2.1	2.7	3.5	4.4	5.7	7.3	9.3
b	3	3	3.2	4	5	6.4	8	10	12.6	16	20
c	1.8	2	2.8	3.6	4.6	5.8	7.4	9.2	11.8	15	19
L	6-20	8-20	8-20	10-20	12-50	18-80	20-80	20-80	28-80	36-80	56-80

mm

### COTTER PINS

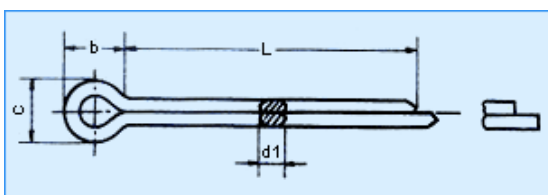
**B.S.**

Nominal	3/32	7/64	1/8	9/64	5/32	11/64	3/16	7/32	1/4	9/32	5/16	3/8
d1	2.11	2.57	2.70	3.36	3.51	4.09	4.40	5.29	5.69	6.86	6.29	9.10
b	4.83	5.59	6.35	7.11	7.87	8.64	9.65	11.18	12.7	14.22	15.75	19.05
c	4.72	5.48	6.29	7.11	7.87	8.68	9.44	11.07	12.64	14.22	15.97	18.94
L(In)	3/8-7/8	3/8-2	1/2-3	1/2-3	5/8-3	5/8-3	5/8-3	3/4-3	3/4-3	1 1/2-3	1 1/2-3	1 1/2-3

inches

## BLIND RIVET

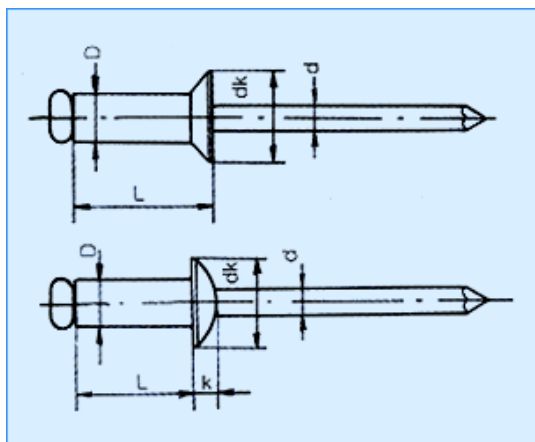

Nominal	3	3.2	4	4.8	5
L	4.8-16	4.8-18	4.8-22	6.4-30	6.4-30
dk	6	6	8	9.5	9.5
k	1	1	1.4	1.5	1.5
d	1.8	1.8	2.2	2.6	2.8

mm

## SEALED TYPE ALUMINIUM BLIND RIVET

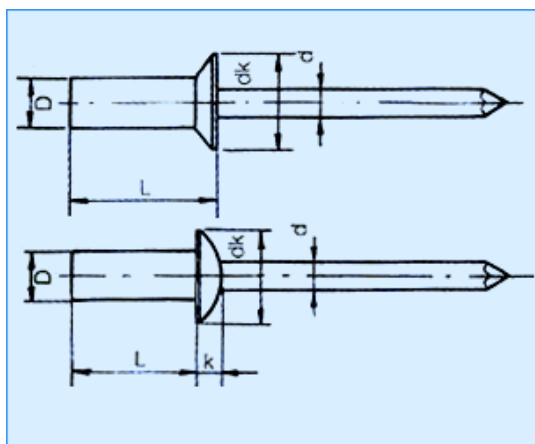

Nominal	3.2	4	4.8	5
L	5-18	5-22	8-30	8-30
dk	6	8	9.5	9.5
k	1	1.4	1.5	1.5
d	1.7	2.2	2.64	2.8

mm



## BOLT ANCHORS

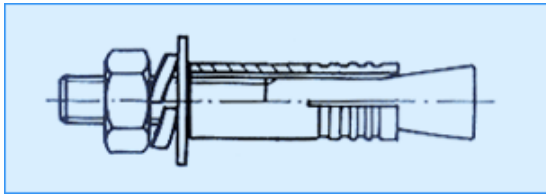

Thread size	M6	M8	M10	M12	M16	M20	M22	M24
-------------	----	----	-----	-----	-----	-----	-----	-----

## CUT ANCHORS

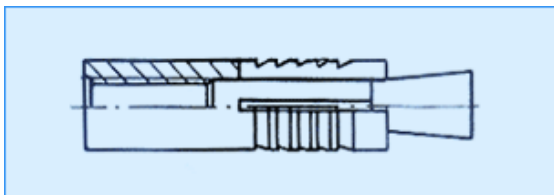

Thread size	M6	M8	M10	M12	M16	M20	M22
Length	30	35	40	52	63	83	93

mm

## SLEEVE ANCHORS

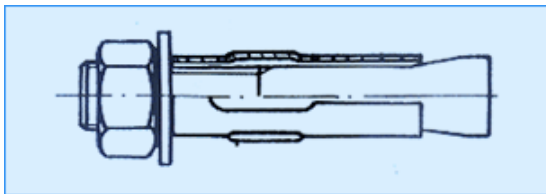

Nominal size	6.5	8	10	12	16	20
--------------	-----	---	----	----	----	----

mm

## WEDGE ANCHORS

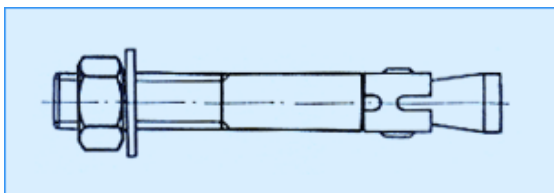

Thread size	M6	M8	M10	M12	M16	M20
Length	49-95	50-220	65-250	75-250	90-250	90-300

mm





## TIE WIRE ANCHOR

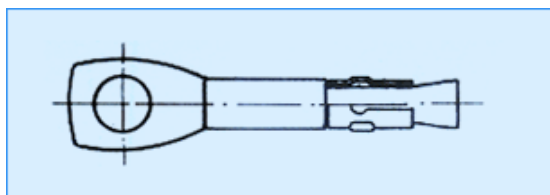

Nominal size	6	6
L	60	67

mm

## DROP IN ANCHORS

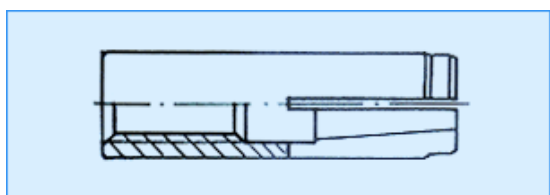

Thread size	M6	M8	M10	M12	M16	M20
Length	25	30	40	50	65	80

mm

## HEAVY-DUTY SHELLANCHOR

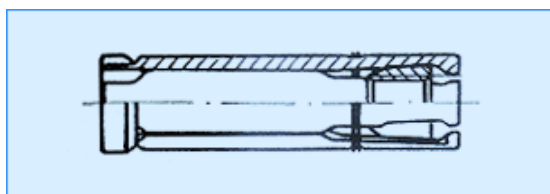

Thread size	M6	M8	M10	M12	M16	M20
Length	45	55	60	75	115	130

mm

## NYLON HAMMER FIXING

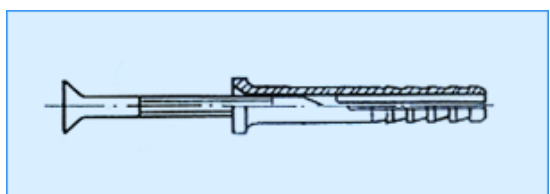

Nominal size	5	6	8
Length	20-50	35-80	60-135

mm

## THREADED RODS AND OTHERS

### THREADED ROD

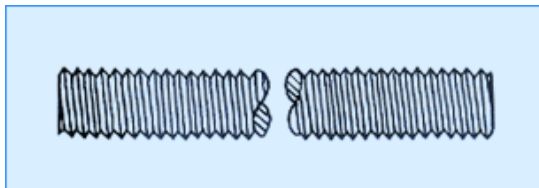

Thread size	M6	M8	M10	M12	M14	M16	M18	M20	M22	M24
LENGTH	1000mm-40000mm									

mm

Thread size	1/4	5/16	3/8	7/16	1/2	9/16	5/8	3/4	7/8	1
LENGTH	3feet-12feet									

inches

### WIRE ROPE CLAMPS

**DIN 741**

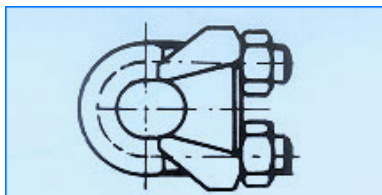

for rope dia	3	5	6.5	8	10	11	13	14	16
Thread size	M4	M5	M5	M6	M8	M8	M10	M10	M12

mm

### HEX HEAD PIPE PLUGS

**DIN 910**

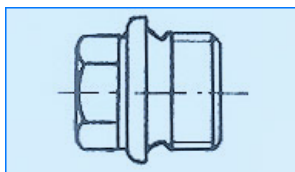

Thread size	M10	M12	M14	M16	M18	M20	M22	M24	M26	M30	M36
-------------	-----	-----	-----	-----	-----	-----	-----	-----	-----	-----	-----

### STEEL PIPE SCAFFOLD

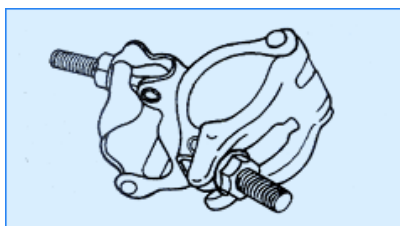

## GREASE FITTING

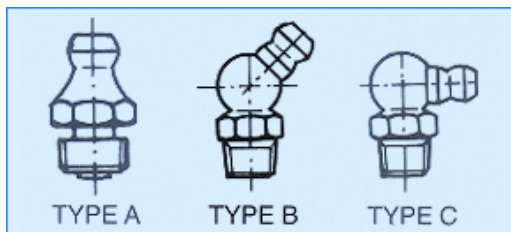

Thread size	6×1	8×1	8×1.2	10×1

## RELATED PRODUCTS

[Washers](#), [Screws and bolts](#), [Nuts](#), [Threaded rods](#), [Gas springs](#),

## CONTACT:

In **Gestión de Compras** work with a wide range of customers from different sectors but have in common the search for products that suit your needs at the best Price and the guaranteed maximum quality. Check with us about any product. We have a qualified staff who will advise you.

**C/ Nueva 35**

**02002 Albacete (Spain)**

**Phone: + (34) 967 221 602**

**Fax: + (34) 967 223 369**

**Email: [info@gestiondecompras.com](mailto:info@gestiondecompras.com)**



Contact us now!!